

**4050 sq ft**

Apartment: 2785 sq ft  
Deck & Pool: 1265 sq ft

**“NO TAN-LINES” PRIVACY**  
Expansive, private patio with two (2) infinity-edge private pools with hot tubs - one 37ft wide for the main residence and the other 19ft wide for the “lock-off” studio.

**INDOOR - OUTDOOR LIVING**  
Floor-to-ceiling glass windows for spectacular ocean views

**WAKE UP TO A DREAM**  
Grand master bedrooms face the same breathtaking views as the living spaces.

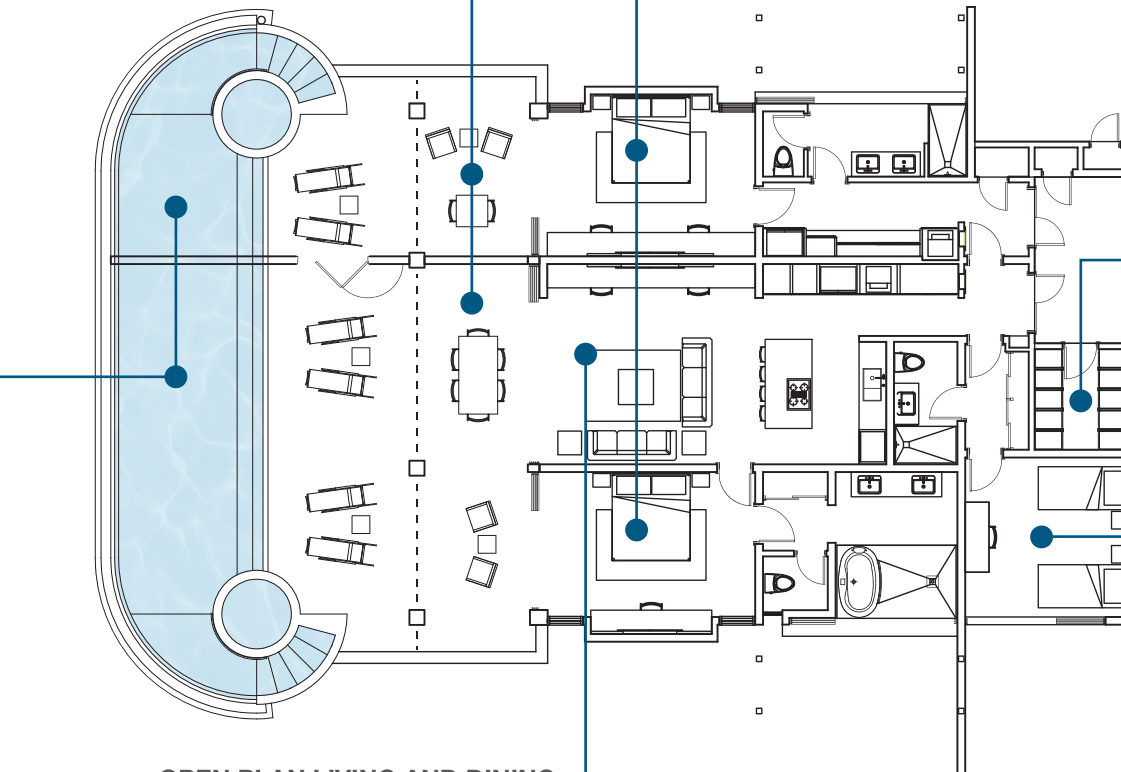

**OPEN PLAN LIVING AND DINING**  
Grand kitchen complete with granite counter tops and top-of-the-line appliances.

**OWNERS STORAGE**  
When you are not using your residence, enjoy peace of mind with conveniently located storage.

**ROOM TO SPARE**  
Second bedroom welcoming in the greenery of tropical internal gardens with the added convenience of a semi en suite / en suite bathroom.

*The above are artistic impressions intended for visual purposes only. Floor plan areas are approximate and not necessarily to scale. Square footage represents a typical unit.*

**3 BEDROOM BEACH HOUSE  
WITH LOCK-OFF**

**BEACH HOUSES**  
EAST COAST • BARBADOS